



MEETING MINUTES DAG MEETING #3

OH PLANNING+DESIGN, ARCHITECTURE

Oh Project No.: 90031

Project Name: Portland Public Schools - Kellogg Middle School Replacement
Date & Location: 11/07/17 @ Franklin High School
Prepared by: Tim Ayersman
Present: DAG: (*: Present, A: Absent)

*Michael Burton (MB)	A Danielle Meyer (DM)
A Alicia O'Brien (AO)	* Kara Mortimer (KM)
*Scott Morris (SM)	*Lisa Kensel (LK)
A Christy Thomas (CT)	*Chuck Billedeaux (CB)
* Kathryn Schmidt (KS)	*Brian Harper (BH)
A Stephen Karmol (SK)	*Hannah Back (HB)
A Maija Anderson (MA)	A Kyla Tanaka (KT)
*Sarah Richardson Green (SR)	A Rick Toth (RT)
A Sarah Toth (ST)	*Collin Cordoza (CC)
*Aron Goffin (AG)	*Nathan Junkert (NJ)
*Tina Kimmey (TK)	A Kieran O'Donnell (KO)
A Noelle Harding (NH)	A Erin Telford (ET)
A Shelley Rouleau (SR)	A Ben Wixon (BW)
* Judy Hilsenteger (JH)	A Jaime Cale (JC)
*Pam Joyner (PJ)	A Toby Nicastro (TN)
*Ana Munoz (AM)	

PPS: Derek Henderson (DH) – Senior Specialist-OSM Support
Stephen Effros (SE) – Project Manager
TDR: Tamara DeRidder (TD) – Community Outreach Consultant
OHP+D: Deb France (DF) Tim Ayersman (TA)
Bryan Thompson (BT) Christine Nelson (CN)
Juan Carlos Garduno (JG) Samantha Aleo (SA)
Colin McNamara (CM) Sheena Hewett (SH)

Distribution: Attendees; Dan Jung – PPS; John Hinds – PPS; Ken Fisher – Heery; file

The purpose of the meeting is to tour the new Faubion K-8 facility reviewing similar program spaces and a site planning activity with the Design Advisory Group (DAG).

Item 1. DAG Roles Recap.

- A. The DAG role is to bring in ideas and concerns from the community, and also share information from DAG meetings with the community.
- B. If you have a special interest in a specific area of the design, make it relevant and important to the whole group, not just its impact on you personally.
- C. The roles were printed out on the back of the agenda for easy reference.

Item 2. Site Exercise. Eight specific questions relating to the site design were presented to the DAG for their input. Refer to the attached DAG 3 Site Question for responses.

- A. Question 1: Should the parking be closest to the entrance?
- B. Question 2: Should the bus loop be parallel to 69th?
- C. Question 3: Should the deliveries be from SE Franklin St?
- D. Question 4: Should bike parking be distributed on the site?
- E. Question 5: Should the classroom wings step on Powell?
- F. Question 6: Should the classroom wings on Powell be 4 stories?
- G. Question 7: Should the play structure be on the ground?
- H. Question 8: Should the courtyard on Powell be dedicated to educational use?

Item 3. Tour of the new Faubion PK-8 school comparing similarities and differences to the new Kellogg Middle School.

- A. Faubion is designed for grades PK-8 with Concordia University staff and students. It is 100,000 square feet with 33,000 being used by Concordia and has a maximum PPS student population of 675 students.
- B. The new Kellogg Middle School is designed for grades 6-8. The current size is 100,412 square feet for 675 students and a design capacity to grow to 810 students.

- C. The media center ed specs require 1,650 SF and have an add of 1,550,SF for a total of 3,200 SF. Faubion has 1,650 SF meeting the required whereas Kellogg has 3,650 SF meeting both the required and preferred. (Faubion was noted as being 3,860 SF on the tour handout, that incorrect.) Faubion is adjacent to the STEAM lab and general classrooms where as Kellogg is adjacent to the cafeteria/commons and general classrooms.

Kellogg MS
MEDIA CENTER - NTS

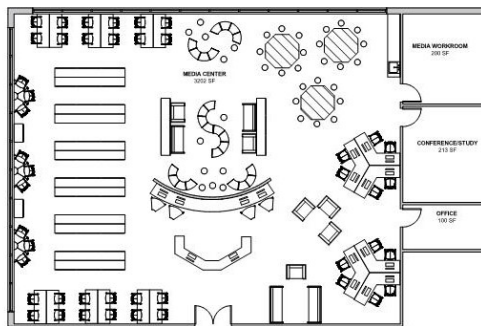

PPS Faubion PK-8
MEDIA CENTER - NTS

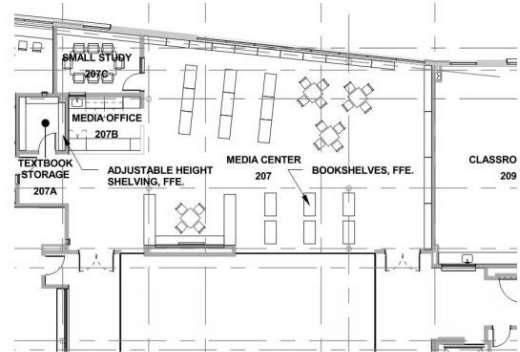

- D. The STEAM lab ed spec's does not have a requirement for this space it does have a prefer add of 1 lab at 1,200,SF to included it in the program. Faubion has 2 STEAM labs one at 1,100 SF and the other at 2,100 SF. Kellogg has one lab at the preferred size of 1,200 SF. Faubion is adjacent to the media center, and science lab, while Kellogg is adjacent to the general classrooms, science, and art classrooms.

Kellogg MS
STEAM LAB - NTS

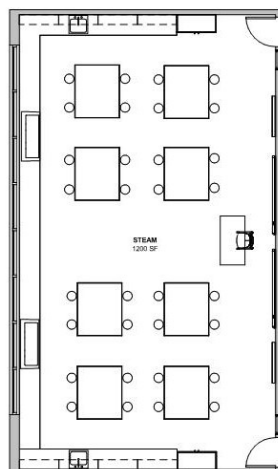

PPS Faubion PK-8
— STEAM-GR -NTS

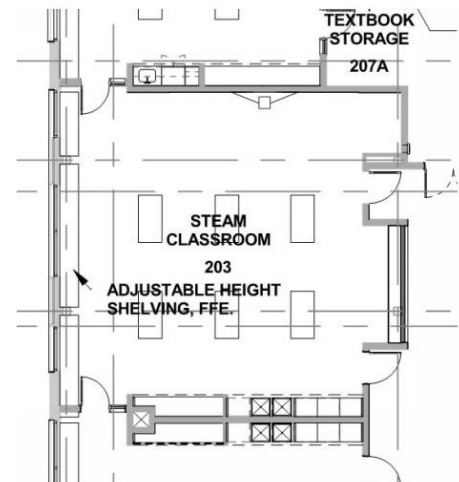

- E. The science lab ed specs require 1,300 SF. Faubion has 1,025 SF, 20% under the required size while Kellogg has 1,300 SF meeting the requirements. Both Faubion and Kellogg are adjacent to the general classrooms.

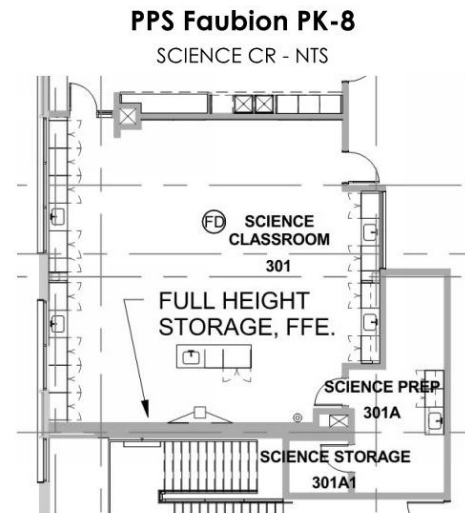
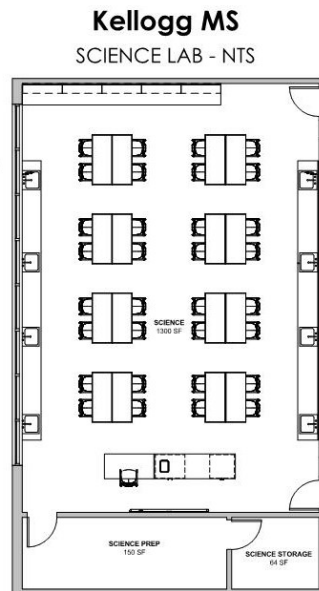

- F. The classroom specs require 980 SF. Faubion has 950 and Kellogg has 980 SF both meeting the required space. Faubion and Kellogg are both adjacent to extended learning and restroom. Faubion has the extended learning centrally located and open to the corridor whereas Kellogg has the extended learning spaces centrally located within the general classrooms with the ability to be open to the corridor or closed off with sound partitions.

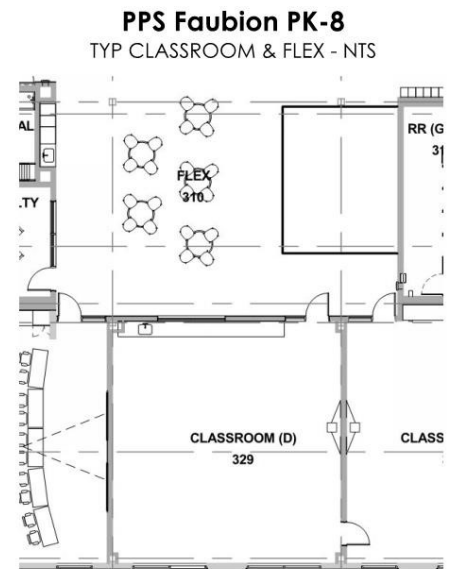
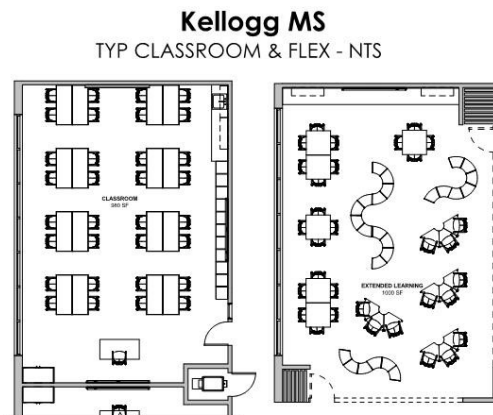

- G. The intensive skill ed specs have a preferred add of 980,SF for this space. Faubion does not have an intensive skills classroom but has a learning resource room that is 866 SF. Kellogg has an intensive skills room at 980 SF and a learning resource room at 800 SF along with three sensory support rooms on each floor at 150 SF. Faubion is adjacent general classrooms and is located on the second floor where as Kellogg has the intensive skills located by the general classrooms on the first floor for direct access to the outdoors. Kellogg’s learning resource is located between grade floors centrally located in the classroom suite.

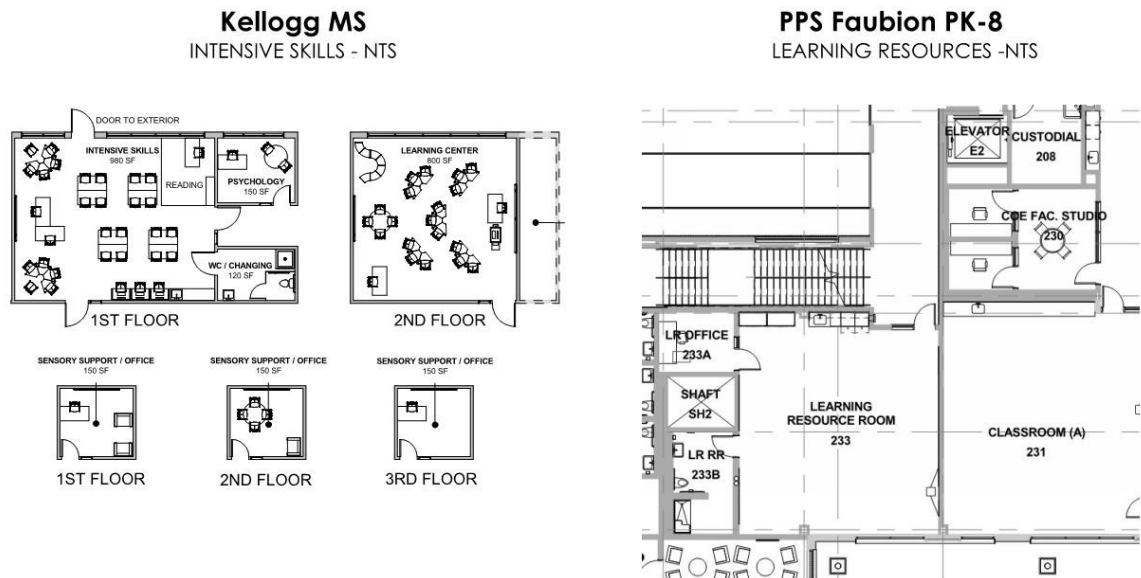

- H. The commons / cafeteria ed specs require 4,250 SF and have a preferred add of 250 SF for a total of 4,500 SF for 2 lunch periods. Faubion has 3,450 SF, 25% under the required and preferred space requirement whereas Kellogg has 6,080 SF. Kellogg is larger than the required and preferred space to meet the actual capacity requirements for two lunch periods for 675 students. Faubion is adjacent to music room, stage, and outdoor courtyard where as Kellogg is centrally located and adjacent to media center and outdoor courtyard.

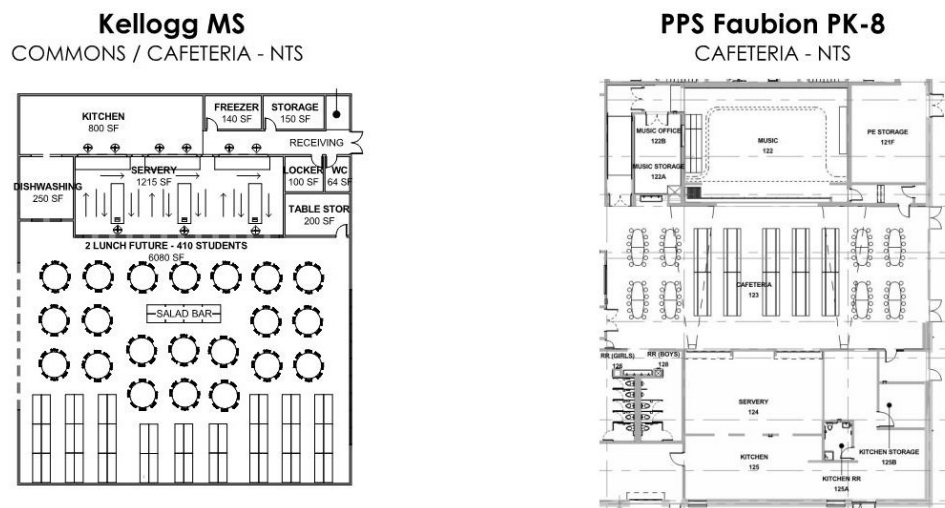

- I. The gymnasium ed specs require 6,800 SF. Faubion has 6,500 SF and Kellogg has 6,800 SF both meeting the required space. Faubion is adjacent to the lockers and outdoor play structure as is Kellogg. Kellogg is also adjacent to the stage, dance, and music rooms.

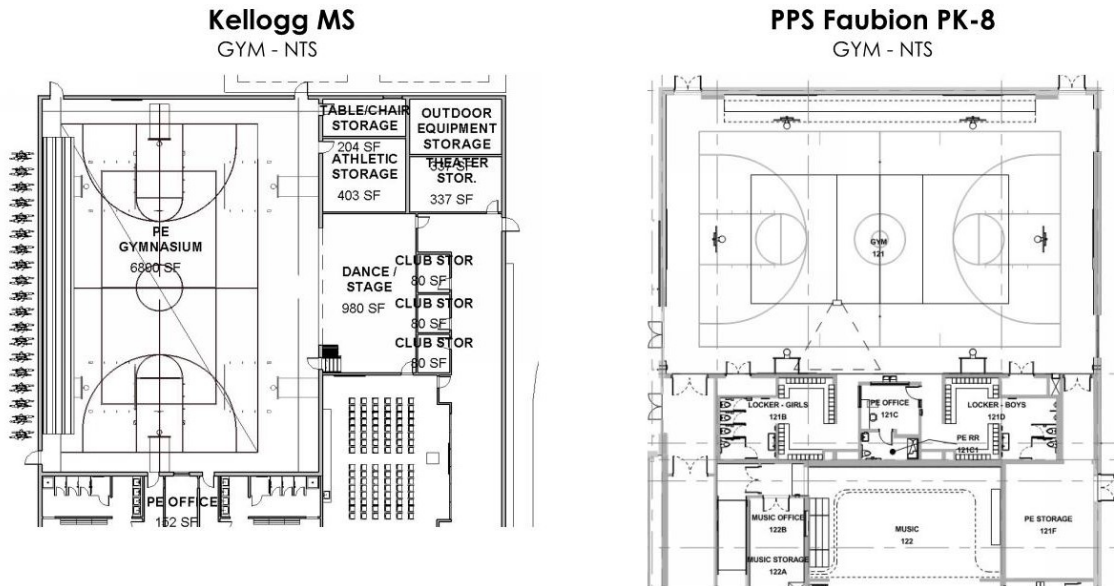

Item 4. Questions and Comments.

- A. Comment Cards were distributed to the DAG members.
- B. It was suggested that a garden roof top may be less expensive than a covered play for the roof top.
- C. What are the expected enrollment numbers for Kellogg and is 810 a realistic maximum number?
- D. Many class spaces on the tour felt small. Be careful of compromising spaces and making the environment feel sterile.
- E. Safety around the school needs to be discussed and clarified.

Item 5. Action Items

- A. The Next meeting is December 7th at Franklin High School.
- B. OHP+D to upload shadow analysis to DAG Facebook page.
- C. OHP+D confirm the existing tree height on Powel



OH PLANNING+DESIGN, ARCHITECTURE

MEMORANDUM

Oh Project Number: 90031
 Project Name: Kellogg Middle School

To:

Date: 11/22/2017

Subject: DAG #3 Site Questions Results
 Prepared by: Samantha Aleo
 Distribution:

The purpose of this memorandum is to provide a summary of the Site Exercise questions from the DAG #3 Meeting on 11/21/17.

During the meeting, the 18 DAG members present were presented with a questionnaire with 8 yes/no questions regarding the site. OHP+D presented a slideshow corresponding with each question, illustrated with graphics representing the yes/no options. The responses of the 18 DAG members are summarized below.

Question 1: Should the parking be closest to the entrance? **Majority response: Yes, 16 : 2**

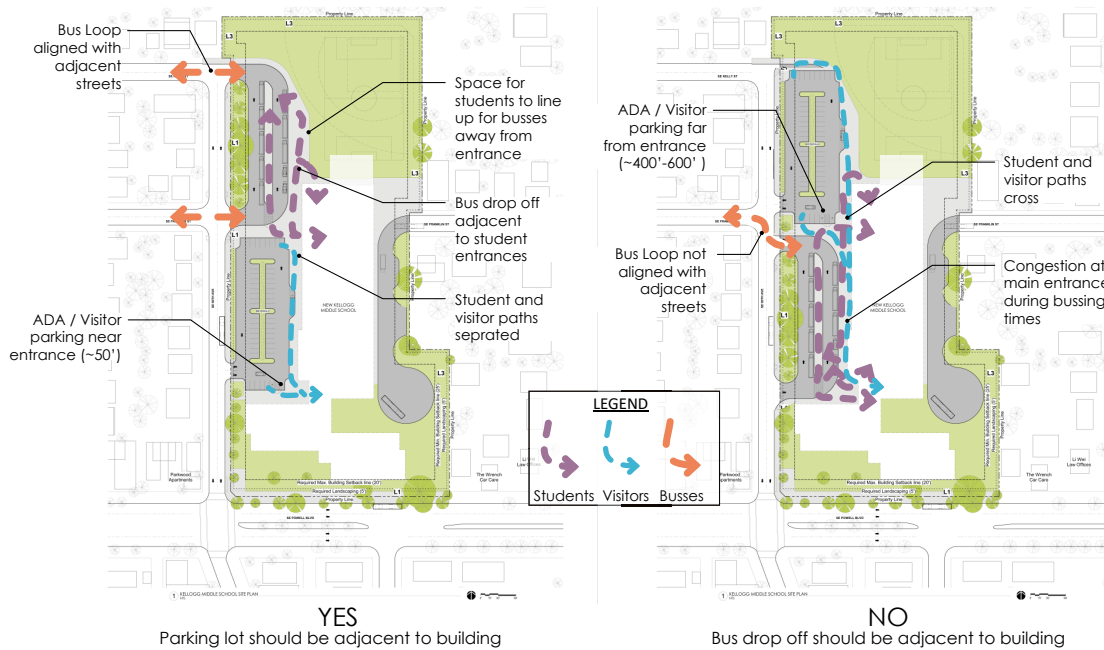

DAG member responses for “Yes”:

- Seems safer for students/pedestrians
- Better security for cars

DAG member responses for “No”:

- Busses should be let off closest to the entrance
- Poor lines of site from main entrance to bus loop

Question 2: Should the bus loop be parallel to 69th? Majority Response: Yes, 17 : 0, 1 undecided



DAG member responses for yes:

- students would not be cutting through busses
- safer and better visibility

Undecided DAG member responses:

- consider extending Franklin through the site as the bus drop location, with the school on one side and play/fields on the other.
- consider using 69th for bus drop-off to reduce number of bus lanes on site (look at Beaumont model)

Question 3: Should the deliveries be from SE Franklin St? Majority Response: Yes, 17 : 0, 1 undecided

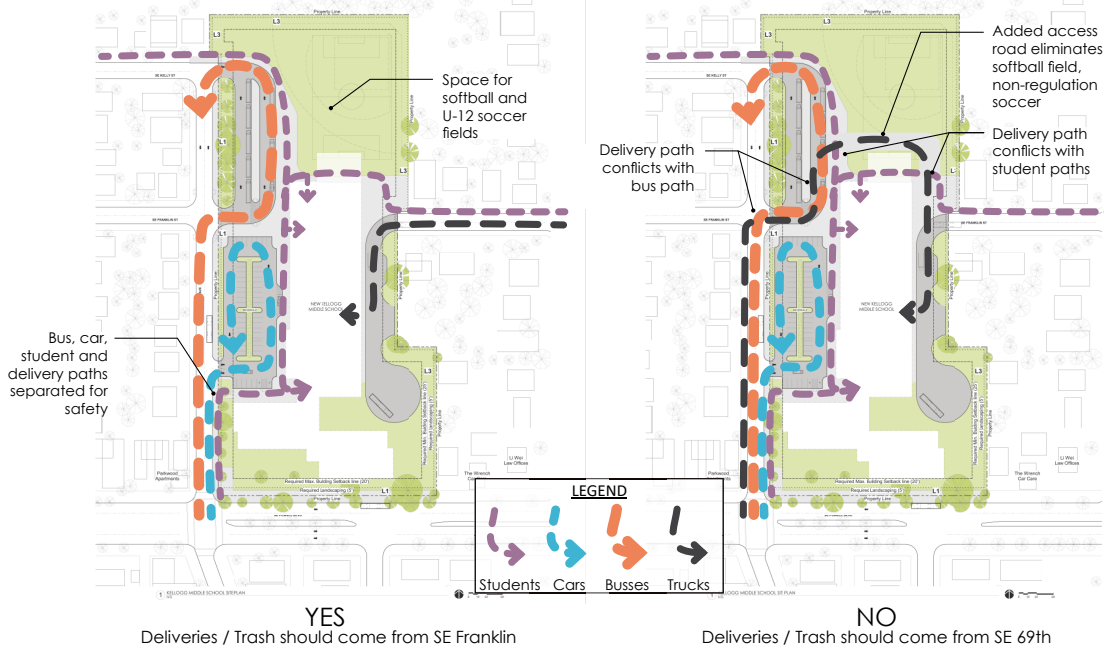

DAG member responses for yes:

- safer, out of the way of kids/pedestrians
- deliveries do not occur frequently enough to warrant neighbor concern

Undecided DAG member responses:

- desire to revisit the use of Franklin access space in relation to neighbors
- consider deliveries only after 6am

Question 4: Should bike parking be distributed on the site? **Majority Response: Yes, 15 : 2, 1 undecided**

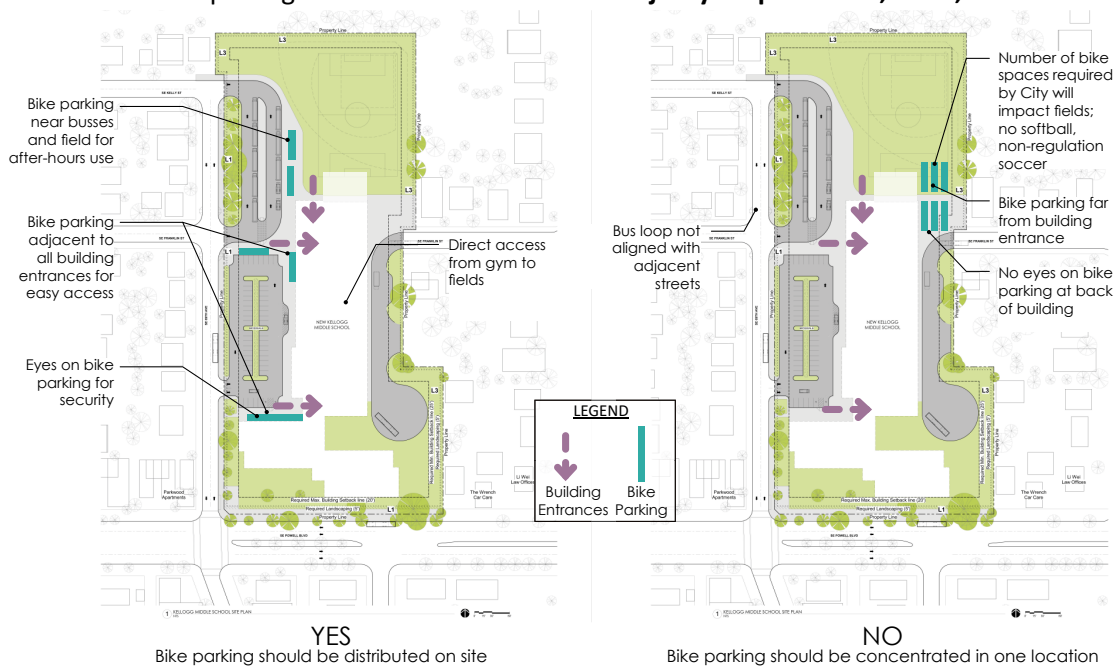

DAG member responses for yes:

- better visibility from administration
- allows after hour use
- concentrated location makes theft easy

DAG member responses for no:

- consider additional distributed and condensed locations
- concentrated bikes could be gated off
- option for security cameras in one location

Question 5: Should the classroom wings step on Powell? **Majority Response: Yes, 13 : 2, 3 undecided**

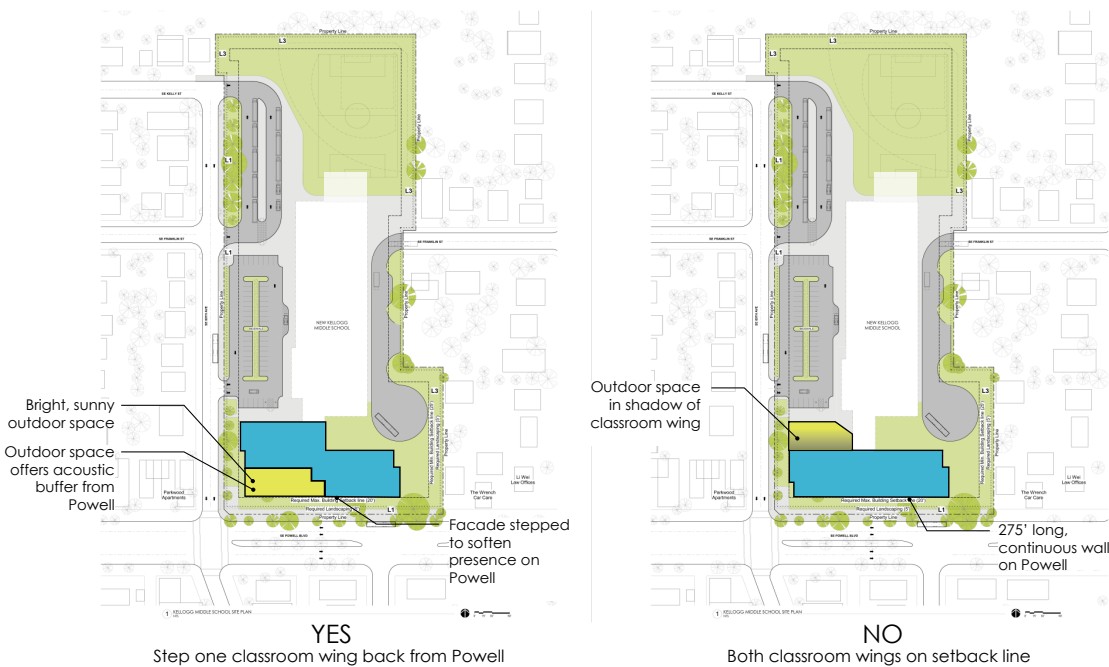

DAG member responses for yes:

- fenced off space provides great opportunities
- great sun exposure for outdoor learning and gardening
- maximizes use of outdoor space

DAG member responses for no:

- unsure about air quality from Powell
- concern about noise level from Powell inhibiting education
- aligned wings could allow opportunity for a creative connection or atrium location

Question 6: Should the classroom wings on Powell be 4 stories? Majority Response: Yes, 17 : 0, 1 undecided

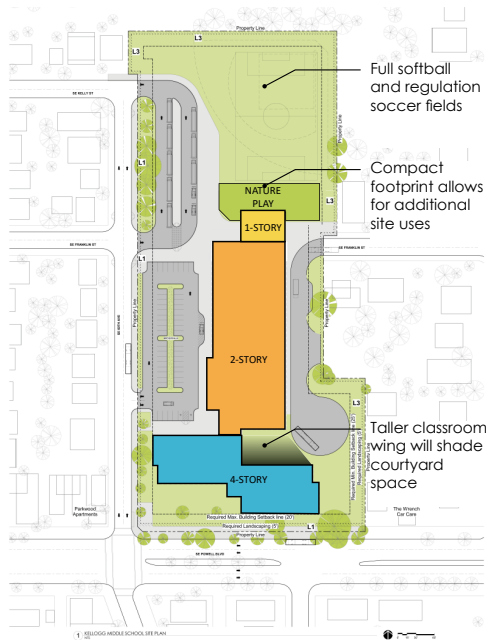

YES
Classroom wings should be 4 stories

DAG member responses for yes:

- more cost effective
- more energy efficient
- allows for more outdoor space and regulation fields

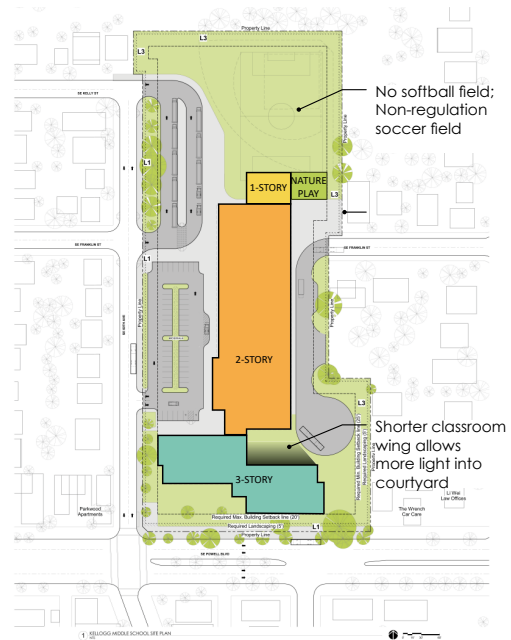

NO
Classroom wings should be 3 stories

Undecided DAG member responses:

- explore option for one 3 story wing and one 4 story wing

Question 7: Should the play structure be on the ground? Majority Response: Yes, 15 : 1, 1 undecided

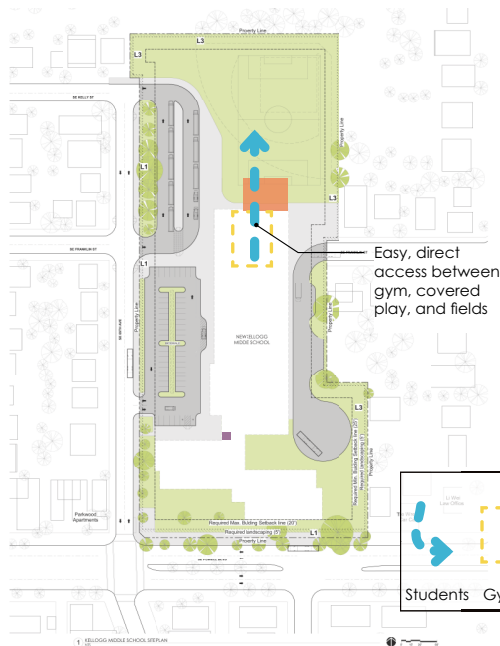

YES
Play structure should be on the Ground

DAG member responses for yes:

- allows community access after hours
- safer, better ADA access

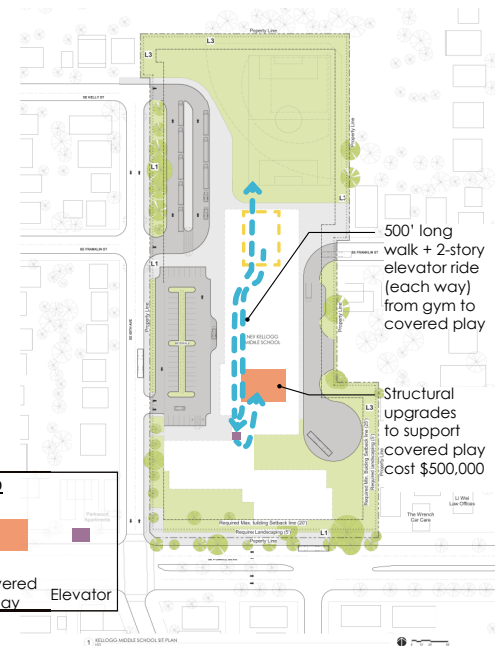

NO
Play structure should be on the roof (Add \$500,000)

Undecided DAG member responses:

- consider alternate rooftop option such as garden / green roof
- cost prohibitive

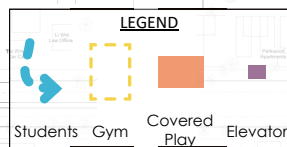

Question 8: Should the courtyard on Powell be dedicated to educational use? **Majority Response: Yes, 15 : 1, 2 undecided**

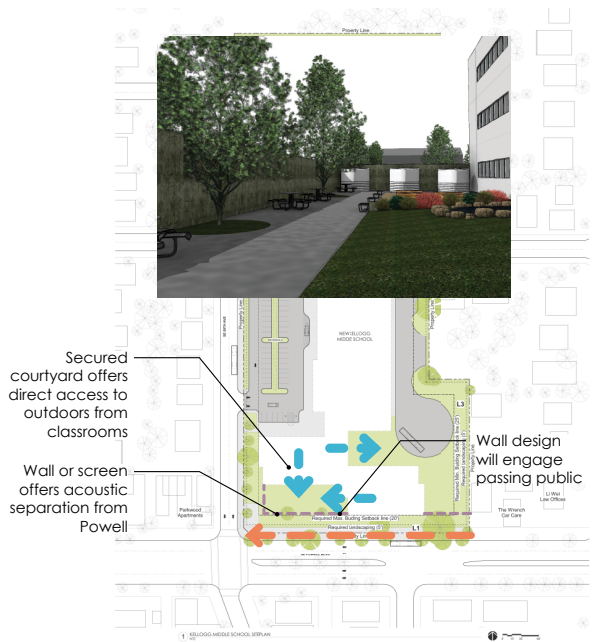

YES

Courtyard space should be separated from Powell for school use only



NO

Courtyard space should be open to the public

DAG member responses for yes:

- fencing off the space creates a nice learning environment, free from litter and debris
- opportunity for outdoor summer lessons
- keeping an open, public courtyard could attract homeless / transients, traffic issues

DAG member responses for no:

- would love to incorporate the community
- enclosing with fences makes the school inaccessible to the community, not as welcoming
- concerns about managing students outdoors near the busy streets